

# Cabinet Door Hinge Adjustment Guide

From time to time, your kitchen cabinets may require adjustment to ensure proper alignment and function. Keep a Phillips head and slotted screwdriver available to make these simple adjustments.

Height adjustment

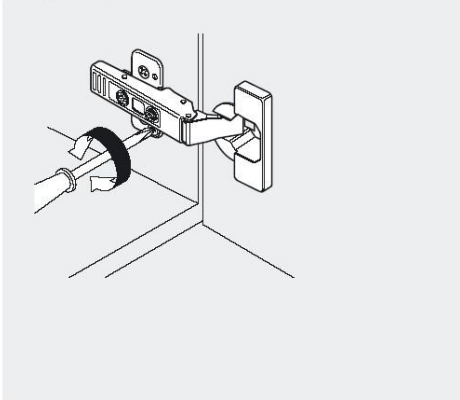

Side Adjustment

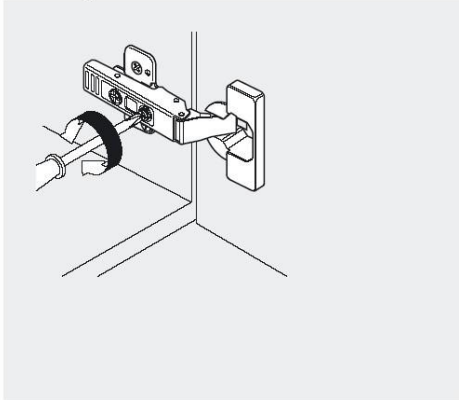

Depth adjustment

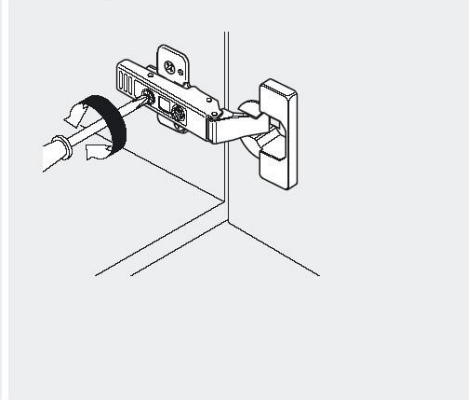

Loose door hinges – Use a Phillips head screwdriver to tighten any door hinges that might have come loose. Locate the screws used to fasten the hinge to the face frame and tighten by turning clockwise.

Doors can be adjusted up and down by slightly loosening the screws used to fasten the hinges to the face frame. Once the screws are loose, move the door to its proper location and hold in place while you re-tighten the screws. Be aware that, sometimes, screws are hidden beneath a cap that will first need to be removed prior to adjustment.

Most doors can be adjusted side to side to close or open the gaps between doors. Use a screwdriver to adjust the screw typically found on the hinge arm that attaches the cup portion found in the door to the plate found on the face frame. Adjust the screw and close the door to view the adjustment made. Fine-tuning this adjustment may take a few tries.

Most doors can also be adjusted in or out to bring the door closer or further away from the face frame. Use a screwdriver to adjust the screw that is typically found on the hinge plate towards the inside of the cabinet.